

3M™ Littmann® Classic III™ Stethoscope User Manual

3M™ Littmann® Classic III™ Stethoscope

- High acoustic sensitivity
- Dual single-piece tunable diaphragms (pressure sensitive)
- Versatile adult and pediatric two-sided chestpiece
- Small-side diaphragm prevents debris in open bell
- Snap tight soft-sealing eartips
- Next generation longer-life tubing
- Small side converts to open bell

Congratulations on the purchase of your new 3M™ Littmann® Classic III™ Stethoscope.

The Littmann Classic III stethoscope provides high acoustic sensitivity combined with exceptional versatility. Its innovative design offers a tunable, single-piece diaphragm on each side of the chestpiece; the large side can be used for adult patients, while the small side is especially useful for pediatric assessment. Plus, the pediatric side of the chestpiece can be converted to a traditional bell by replacing the tunable diaphragm with the nonchill bell sleeve included with your purchase. For more information, visit www.littmann.com.

Explanation of Symbols

 Consult instructions for use.

 Not made with natural rubber latex.

Instructions for Use

Place the Stethoscope in Your Ears

The stethoscope headset is angled to complement the anatomy of the typical ear canal and is designed to provide a comfortable, acoustically sealed fit. The eartips should point in a forward direction as you insert them into your ears.



Adjust the Headset Tension

If necessary, you can adjust the tension in the headset to ensure a tight, yet comfortable fit in your ears.

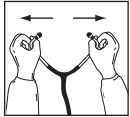

To reduce the spring tension in the headset, pull the eartubes apart. Repeat until the desired tension is achieved.

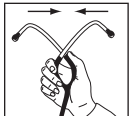

To increase the spring tension in the headset, squeeze the eartubes together. Repeat until the desired tension is achieved.

Select the Active Side of the Chestpiece

The Littmann Classic III stethoscope features a two-sided chestpiece. Only one side of the chestpiece is acoustically active at any one time, which is identified by a mark on the stem. Rotate the chestpiece to change which side is active.

Littmann Tunable Diaphragm - Listen to Low and High Frequency Sounds

Both sides of the chestpiece are equipped with the proprietary Littmann tunable diaphragm that enables you to emphasize either low or high frequency sounds by simply adjusting the pressure applied to the patient.

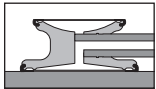

Low frequencies: To emphasize lower frequency sounds, use light pressure against the patient.

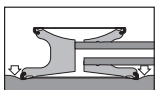

High frequencies: To emphasize higher frequency sounds, use firm pressure against the patient.

Convert to a Traditional Open Bell



The small side of the chestpiece can be used with the Littmann tunable diaphragm or it can be converted to a traditional open bell with the nonchill sleeve included with your purchase.



To remove the Littmann tunable diaphragm, pinch the rim of the diaphragm with your thumb and index fingernails; pull and lift the diaphragm from the chestpiece.



To assemble the nonchill bell sleeve, place one side of the sleeve on the edge of the chestpiece and stretch it over and around the chestpiece edge.



To re-assemble the Littmann tunable diaphragm, remove the nonchill bell sleeve. Insert the flexible edge of the tunable diaphragm into the groove of the rim and slowly roll the rim around and over the chestpiece edge.

Cleaning, Disinfection and Storage

Clean your stethoscope in-between each patient with either a 70% isopropyl alcohol wipe or using a disposable wipe with soap and water. It is a best practice to use a disposable wipe when cleaning the stethoscope to remove organic material.

A 2% bleach solution may be used to disinfect your stethoscope. However, stethoscopes that contain red pigments in the tubing color (Burgundy, Pink, Plum, Peach, Raspberry, Orange, etc) experience slight discoloration after exposure to bleach. Due to the destructive nature of bleach, only use a bleach solution on a limited basis and/or when necessary.

The tunable diaphragms, nonchill bell sleeve and eartips may be removed for thorough cleaning (ensure all parts and surfaces are dry before reassembly). To remove the eartips from the headset, pull firmly. To assemble the eartips, push the small side of the eartip firmly onto the eartube until it snaps fully into place.

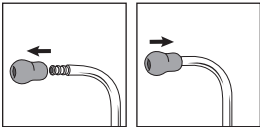

Do not immerse your stethoscope in any liquid.

Do not subject your stethoscope to any sterilization process.

Avoid storing your stethoscope in extreme heat.

Littmann Stethoscope Service and Warranty Program

Please register your stethoscope online at: <http://www.littmann.com/warranty-registration>

The Littmann Classic III stethoscope is warranted against any defects in material and workmanship for a period of five (5) years. Within the warranty period, repairs will be made without charge upon the return of the stethoscope to 3M, except in cases of obvious abuse or accidental damage.

For service and repair in the U.S.A., please visit www.littmann.com/service or call 1-800-292-6298. If you are outside of the U.S.A., please visit www.littmann.com for the contact information of your local 3M office.

3M, Littmann, the L Littmann logo, the L, and Classic III are trademarks of 3M.

Used under license in Canada.

© 2014, 3M. All rights reserved.

Made in U.S.A. by **3M Health Care**,
2510 Conway Ave. St. Paul, MN 55144
(U.S.A.) 1-800-228-3957 Visit our website www.littmann.com



3M, Littmann, the L Littmann logo, the L, and Classic III are trademarks of 3M. Used under license in Canada.

© 2014, 3M. All rights reserved.

Issue Date: 2014-07

34-8715-2908-6

EC REP **3M Deutschland GmbH**
Health Care Business
Carl-Schurz-Str. 1
41453 Neuss
Germany